

Application Site Plans

Planning Committee

Wed 1st Feb
2012
7pm

Council Chamber
Town Hall
Redditch



www.redditchbc.gov.uk

Access to Information - Your Rights

The Local Government (Access to Information) Act 1985 widened the rights of press and public to attend Local Authority meetings and to see certain documents. Recently the Freedom of Information Act 2000, has further broadened these rights, and limited exemptions under the 1985 Act.

Your main rights are set out below:-

- Automatic right to attend all formal Council and Committee meetings unless the business would disclose confidential or “exempt” information.
- Automatic right to inspect agendas and public reports at least five days before the date of the meeting.
- Automatic right to inspect minutes of the Council and its Committees

(or summaries of business undertaken in private) for up to six years following a meeting.

- Automatic right to inspect lists of background papers used in the preparation of public reports.
- Access, on request, to the background papers on which reports are based for a period of up to four years from the date of the meeting.
- Access to a public register stating the names and addresses and electoral areas of all Councillors with details of the membership of all Committees etc.

A reasonable number of copies of agendas and reports relating to items to be considered in public must be made available to the public attending meetings of the Council and its Committees etc.

- Access to a list specifying those powers which the Council has delegated to its Officers indicating also the titles of the Officers concerned.
- Access to a summary of the rights of the public to attend meetings of the Council and its Committees etc. and to inspect and copy documents.
- In addition, the public now has a right to be present when the Council determines “Key Decisions” unless the business would disclose confidential or “exempt” information.
- Unless otherwise stated, most items of business before the Executive Committee are Key Decisions.
- Copies of Agenda Lists are published in advance of the meetings on the Council’s Website:

www.redditchbc.gov.uk

If you have any queries on this Agenda or any of the decisions taken or wish to exercise any of the above rights of access to information, please contact the following:

Janice Smyth

**Member and Committee Support Services Assistant
Town Hall, Walter Stranz Square, Redditch, B98 8AH
Tel: (01527) 64252 Ext. 3266 Fax: (01527) 65216**

e.mail: janice.smyth@bromsgroveandredditch.gov.uk

Minicom: 595528

PLANNING COMMITTEE

1st February 2012

7pm

Council Chamber Town Hall

Agenda

Membership:

Cllrs: Michael Chalk (Chair) Bill Hartnett
Roger Hill (Vice-Chair) Robin King
Peter Anderson Wanda King
Andrew Brazier Brenda Quinney
Malcolm Hall

<p>4. Planning Application 2011/258/FUL - Teardrop Site, Bordesley Lane, Redditch</p> <p>(Pages 1 - 2)</p>	<p>To consider a Planning Application for the erection of a Petrol Filling Station, including forecourt shop, canopy and eight pumps, car wash, car care facilities, car parking, offset fills and associated plant and landscaping.</p> <p>Applicant: Sainsbury's Supermarket Ltd</p> <p>(Site Plan attached) (Abbey Ward);</p>
<p>5. Planning Application 2011/329/S73 - Unit 1 Matchborough Centre, Matchborough Way, Redditch</p> <p>(Pages 3 - 4)</p>	<p>To consider a Planning Application for the variation of Condition 1 of Planning Application 2009/019/COU in respect of a change of use from A1 (Retail) to D2 (Assembly and Leisure), in order to extend the date of expiry of the permission for an additional five years.</p> <p>Applicant: Mr S Marshall (Your Ideas)</p> <p>(Report attached – Site Plan under separate cover) (Matchborough Ward);</p>
<p>6. Planning Application 2011/334/FUL - 9 Dale Road, Riverside</p> <p>(Pages 5 - 6)</p>	<p>To consider a Planning Application for a proposed two storey extension and alterations.</p> <p>Applicant: Mr S Hussain</p> <p>(Site Plan attached) (Abbey Ward);</p>
<p>7. Planning Application 2012/011/GDO - Verge east of Claybrook Drive, Redditch</p> <p>(Pages 7 - 8)</p>	<p>To consider a Planning Application for a 15m monopole, equipment cabinet and ancillary apparatus.</p> <p>Applicant: Vodaphone (UK) Ltd and Telefonica 02 (UK) Ltd</p> <p>(Site Plan attached) (Matchborough Ward);</p>

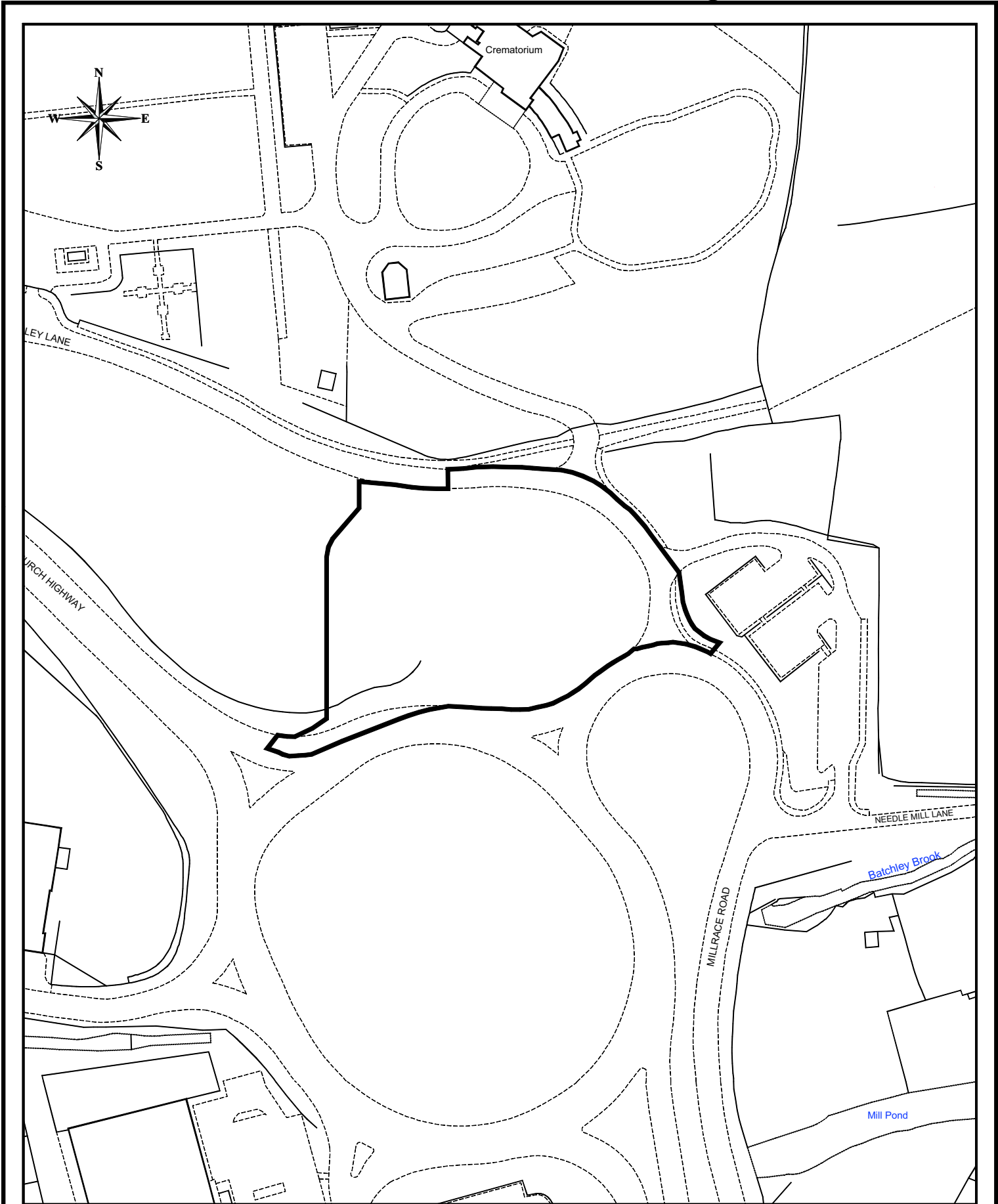

www.redditchbc.gov.uk

Planning Services
Town Hall
Walter Stranz Square
Redditch
Worcs B98 8AH

Project: **2011/258**

Drawn: DW

Drawing: **PFS at Teardrop Site**

Scale: 1/1500

Drawing No: **P2118/101**

Date: JAN 2012

Reproduced from the Ordnance Survey Mapping with the permission of the Controller of Her Majesty's Stationery Office. © Crown Copyright. Unauthorised reproduction infringes Crown Copyright and may lead to prosecution or civil proceedings.
Redditch Borough Council LA100024252 2012

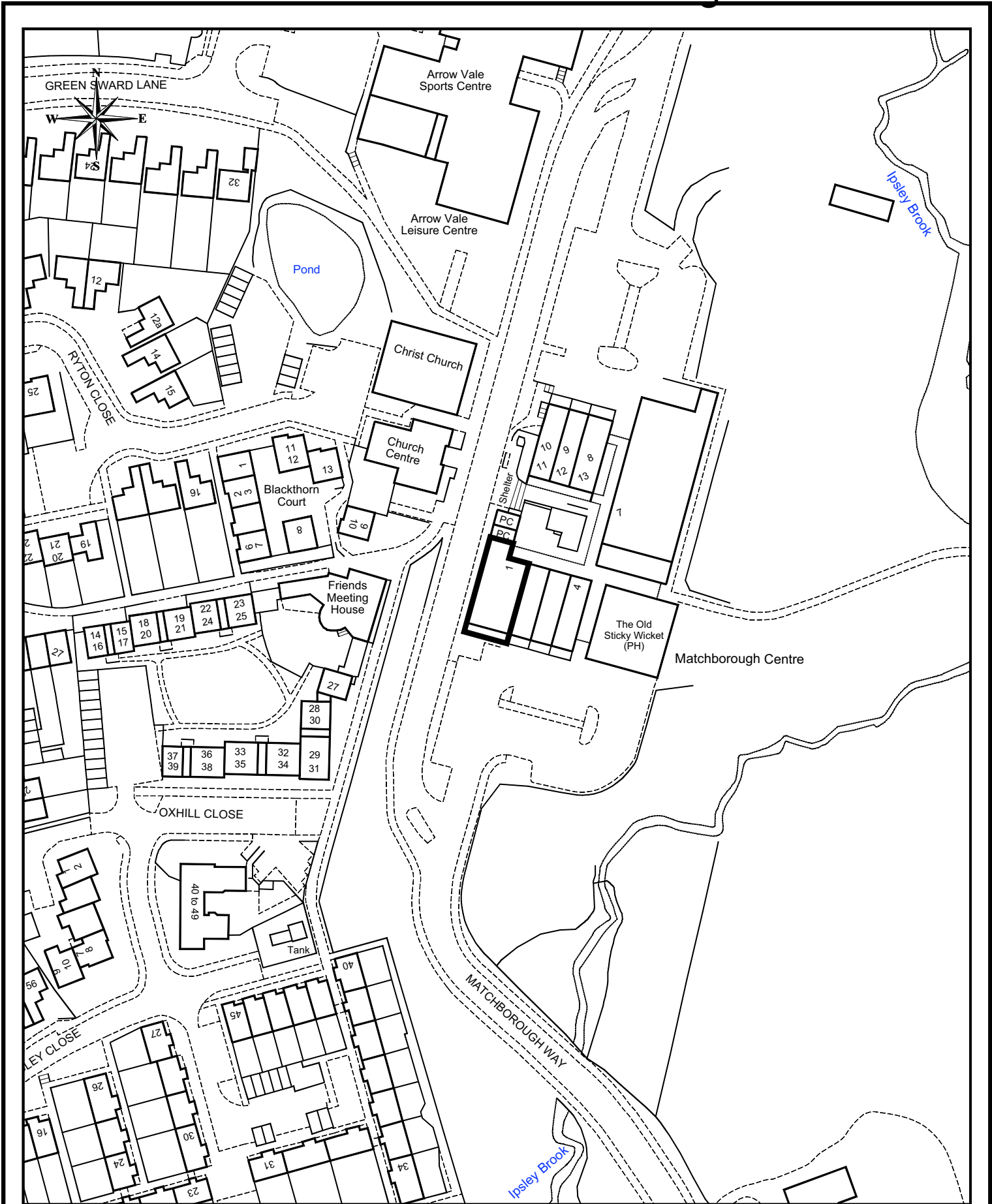

www.redditchbc.gov.uk

Planning Services
Town Hall
Walter Stranz Square
Redditch
Worcs B98 8AH

Project: 2011/329

Drawn: DW

Drawing: **S73 application - Variation of condition 1 of 2009/019/COU Unit 1 Matchborough Centre**

Scale: 1/1250

Drawing No: P2118/100

Date: JAN 2012

Reproduced from the Ordnance Survey Mapping with the permission of the Controller of Her Majesty's Stationery Office. © Crown Copyright. Unauthorised reproduction infringes Crown Copyright and may lead to prosecution or civil proceedings.
Redditch Borough Council LA100024252 2012



www.redditchbc.gov.uk

Planning Services
 Town Hall
 Walter Stranz Square
 Redditch
 Worcs B98 8AH

Project:	2011/334
Drawing:	Proposed alterations and 2 storey extension Dale Road
Drawing No:	P2118/102

Drawn:	DW
Scale:	1/1250
Date:	JAN 2012

Reproduced from the Ordnance Survey Mapping with the permission of the Controller of Her Majesty's Stationery Office. © Crown Copyright. Unauthorised reproduction infringes Crown Copyright and may lead to prosecution or civil proceedings.
 Redditch Borough Council LA100024252 2012

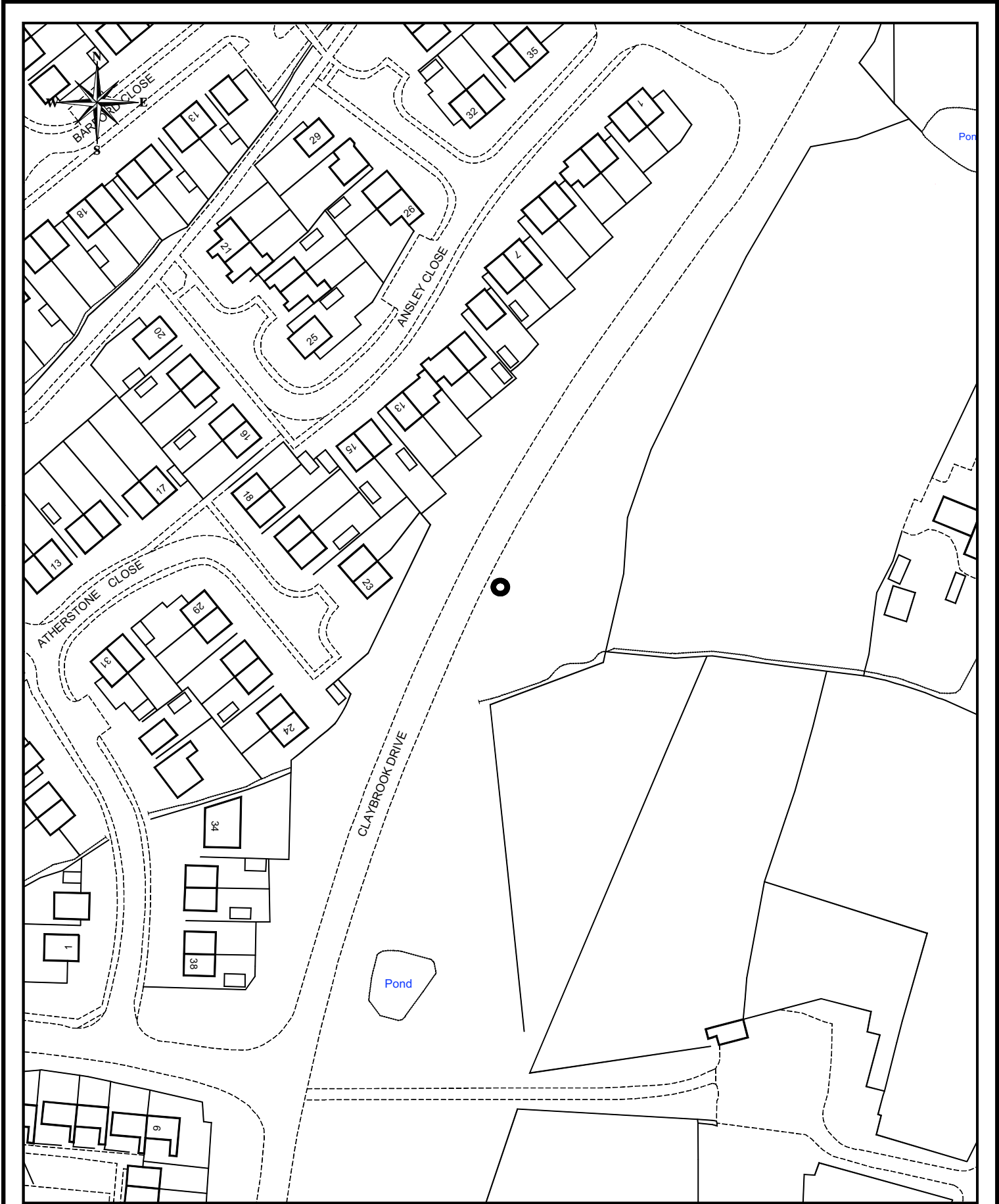

Planning Services
 Town Hall
 Walter Stranz Square
 Redditch
 Worcs B98 8AH

Project:	2012/011
Drawing:	15M Monopole off Claybrook Drive
Drawing No:	P2118/104

Drawn:	DW
Scale:	1/1250
Date:	JAN 2012

Reproduced from the Ordnance Survey Mapping with the permission of the Controller of Her Majesty's Stationery Office. © Crown Copyright. Unauthorised reproduction infringes Crown Copyright and may lead to prosecution or civil proceedings.
 Redditch Borough Council LA100024252 2012

